



2018 58 Super Sport



POWERPLANTS

Twin MAN V12 1400, 1550, 1650 MHP Diesels
Twin CAT C32A 1662 MHP Diesels

STANDARD EQUIPMENT

ENGINE ROOM AND PROPULSION

Sound & heat insulated engine room
Anti-fouling bottom paint
Awlgripped engine room, lazarette & bilges
Twin diesel, water cooled engines with lubricating oil & recovery systems
Engine synchronizer
Engine hour meters
Alternators
Fuel filters – main engines & generator
Propellers (2) – Nibrall
Shafts (2) – Aquamet 22
Bronze rudders & struts
Trim tabs with indicators on flybridge
External sea strainers – generator & air conditioning
Fiberglass mufflers w/surge protector
Automatic fire extinguisher system with safety shutdown
Electric oil exchange system – engines, transmissions & generator
Heat recovery bottles – engines & generator
Electric fuel priming pump
Fuel transfer pump
Engine room cross-ventilation
Fresh water spigot in engine room
Electrical outlet, GFCI
Dripless rudder ports and shaft seals

ELECTRICAL SYSTEM

Generator 15 kW – water cooled
50' Shore cords (2) – 50A/240V, with automatic cord reels
Electrical outlets, 120V with GFCI protection
Batteries (8) – heavy duty, deep cycle/cranking battery (two banks)
Dyna plate ground system
Battery parallel system - Automatic
Automatic digital battery charger
Internal bonding system
Electrical panel with circuit breakers, voltmeters & battery condition indicator
Zoned air conditioning with reverse cycle heating
Zinc anodes
Galvanic isolator
12V step-down transformer for flybridge

LIGHTING SYSTEM

Navigation lights
Cockpit courtesy lighting
24V & 120V lighting throughout
Engine room lighting – 24V & 120V
Back lighting on electrical panel & flybridge instruments

WATER SYSTEM

Hot water heater – 20 gallon²
Water pressure system
Enclosed shower sump pump – 24V (automatic)
Faucets
Central main drain aft
VacuFlush head system
Holding tank – 42 gallons²
Dockside water connection with pressure reduction valve

DECK AND OUTFITTING

Bow pulpit with anchor roller
Rope locker with freshwater washdown
Aluminum bow rail
Window rails – aluminum, powdercoated
Cleats (12") – 3 bow, 4 spring, 2 stern
Hawse pipes (2)
Docklines (6) – 35' x 5/8"
Fenders (2) – 8 1/2" x 28"

SAFETY AND NAVIGATION

Anchor – 65 lb danforth
Anchor chain – 15'
Anchor line, 300' x 9/16"
Fog bell
Deluxe air horns
Fire extinguishers – 2 1/2 lb portable (3) & 5 lb portable (1)
Carbon monoxide & smoke detectors (5)
First aid kit
Olin flare kit
Life jackets – Type I (6) Type IV (1)
VHF radio with antenna
Furuno RD-33 System for water depth & temperature
Compass – 4" flush mount
Power steering
Electronic controls with Palm Beach style handles (open flybridge)
Seacocks (quick-action ball valve) – on all through-hull fittings below waterline
Fuel shutoff valves (quick-action ball valve)
Engine alarm system
Bilge pumps – automatic (4)
High bilge water alarm
Tinted safety glass

COCKPIT

Molded fiberglass, self bailing
Molded live baitwell in transom
Rod holders (4)
Seawater & freshwater washdowns
Insulated fishboxes with pumpout (2)
Lazarette access
Transom door & hinged gate
Under-hatch dunnage bin
Boarding step box

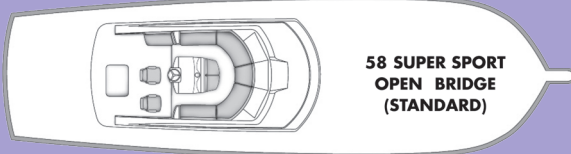

**58 SUPER SPORT
OPEN BRIDGE
(STANDARD)**

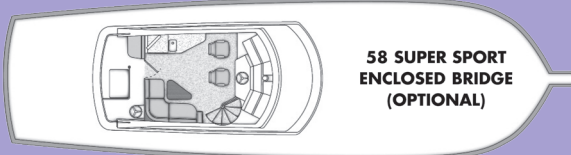

**58 SUPER SPORT
ENCLOSED BRIDGE
(OPTIONAL)**

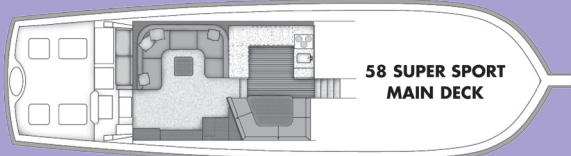

**58 SUPER SPORT
MAIN DECK**

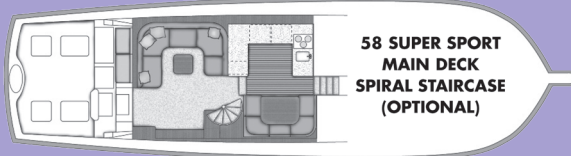

**58 SUPER SPORT
MAIN DECK
SPIRAL STAIRCASE
(OPTIONAL)**



**58 SUPER SPORT
LOWER DECK
(PLAN A - STANDARD)**

SPECIFICATIONS

Length.....	57'11"	17.65 m
Beam.....	16'10"	5.13 m
Draft.....	4'4"	1.32 m
Freeboard, Bow.....	6'3"	1.90 m
Freeboard, Stern.....	3'7"	1.09 m
Fuel Capacity ²	1,150 gal.....	4,353.22 l
Water Capacity ²	200 gal.....	757.08 l
Displacement.....	67,469 lb.....	30,604 kg
Height (waterline to top of hardtop).....	17'5"	5.31 m
Headroom (most areas).....	6'5"	1.96 m
Sleeping Capacity.....	6 plus	

The Best Part Of Life Is Spent On An Ocean

STANDARD EQUIPMENT

MEZZANINE

Bait prep center with drawers, sink & fresh water spigot
In-deck freezer
Lounge seat with cushions, storage & drawers
Molded steps to cockpit
Engine room access
Insulated drink box (in salon entry step)

OPEN FLYING BRIDGE (STANDARD)

Fully instrumented, molded fiberglass open flying bridge
Hardtop with molded-in spreader lights & 3-sided enclosure
Pompanette Tournament Series teak ladderback helm & companion chairs (2)
Aluminum ladder & aft safety rail with 6 rocket launchers
Chart light
Electrical sub-panel
Electrical outlet (120V)
Accessory outlet (12V)
Fuel gauges
Lounge seating with bolstered cushions & storage
Insulated coolers (2)
VHF radio compartment recessed in hardtop with 12V actuation

ENCLOSED FLYING BRIDGE (OPTION)

Fully instrumented, molded fiberglass enclosed flying bridge
Spreader lights
Pompanette Prestige Series helm & companion chairs (2)
Aluminum ladder & aft safety rail with 6 rocket launchers
Electrical sub-panel
Electrical outlet (120V)
Fuel gauges
Wood finished and upholstered helm face
L-shaped lounge seating with table
Aluminum door
Tinted safety glass
Windshield wipers and defogger
Air conditioning with reverse cycle heat
20" flatscreen TV, DVD player & remote
Spiral staircase to salon
Aft deck steering with electronic controls
Aft deck seat
Headliner, valances & carpeting
Wet bar with refrigerator/icemaker & storage
Courtesy lighting

SALON

Aluminum sliding door with security lock
Carpeting, with canvas runner
Upholstered panels & valances
Headliner
Silhouette blinds
U-shaped lounge seating with rod storage
Central vacuuming system
Zoned air conditioning with reverse cycle heating
Icemaker
40" flatscreen TV
Bose Lifestyle V35 stereo with remote
Cocktail table with storage
Personal choice interior decor (custom)

GALLEY/DINETTE

Corian® countertop & sink
Amtico® flooring
Convection/microwave oven
Recessed 3-burner range
Trash compactor
Sub-Zero under counter drawer-style refrigerators (2) & freezer (1)
U-shaped dinette with adjustable hi-gloss table
Spacious drawers & cabinets
Ground fault electrical outlets
Instant hot water faucet
Exhaust blower
Water tank gauge

MASTER STATEROOM

Queen berth with innerspring mattress & drawer storage
Fitted sheet set
Bedspread, pillows (2) & shams (2)
Nightstands (2) with drawers
Hanging lockers (2)
30" flatscreen TV with DVD player & remote
Bose V25 stereo system & speakers
Private head access
Vanity with mirror & stool
Drawers & cabinets

GUEST STATEROOM – PLAN A

Full berth with innerspring mattress
Fitted sheet set
Bedspread, pillows (2) & shams (2)
Hanging locker
20" flatscreen TV with DVD player & remote
Private head access
Cabinets
Deck hatch with screen & shade

GUEST STATEROOM – PLAN B

Twin crossover berths with 5" foam mattresses & zippered covers
Fitted sheet set with Pillows (3) & shams (3)
Hanging lockers (2)
Cabinets
Deck hatch with screen & shade
20" flatscreen TV with DVD player & remote
Private head access

CREW STATEROOM

Side by side twin berths with 5" foam

Hanging locker

COMPANIONWAY

Washer & dryer

MASTER, GUEST, AND CREW HEADS

Private showers with automatic enclosed sump pumps & overhead lighting
Vanities with Corian® countertops & sinks
Mirrored medicine cabinets
VacuFlush heads
Amtico® flooring
Towel bars
Exhaust blowers
Lighting – 24V & 110V
Ground fault outlets – 110V
Storage

58SS OPTIONAL EQUIPMENT

ELECTRICAL

- (2) 220V Underwater lights
- 24V bow thruster.....
- Built-in 20" flatscreen TV (crew stateroom)
- Built-in 20" flatscreen TV with DVD player (crew stateroom)
- Outlet – extra 110V duplex, TV outlet
- CD player with AM/FM stereo & speakers (guest or crew stateroom)

DECK AND OUTFITTING

- Lewmar V4 windlass
- Swim platform
- Swim ladder – two step folding.....
- Additional deck hatch with sliding screen & shade
- Teak coverboards
- Teak coamings
- Teak mezzanine & steps.....
- Teak cockpit.....
- Gelcoat hull color (to be approved by Ocean).....
- Spare propellers
- Sea recovery watermaker
- Emergency bilge valves (ea.).....
- Prop Smith – 3" shaft size
- Refrigerated drink box.....

FLYING BRIDGE

- Hatch in hardtop (ea.)
- Costa Clear 3-sided enclosure (in lieu of standard).....
- Upper vents in enclosure (ea.).....
- Aft enclosure
- Air conditioning with reverse cycle heat.....
- Safety hatch for flybridge ladder access
- Electric teaser reels (pair) recessed in hardtop:
Miya Epoch Super US-9 HD
- Power sunroof (enclosed bridge only).....
- Refrigerator / freezers (2) in insulated coolers.....
- Teak helm pod
- Enclosed flybridge package (includes spiral staircase to salon).....
- Clear flybridge carpet cover (enclosed flybridge).....

FISHING EQUIPMENT

- Rod holders (extra each).....
- Rupp riggers with triple box spreaders, 40' poles & flybridge release (pair).
- Rupp center rigger
- Refrigerated fish box.....
- Eskimo Icemaker, EI 540
- Trolling Valves

INTERIOR

- Sofa bed.....
- Amtico® flooring at salon entrance
- Amtico® flooring under dinette (in lieu of standard).....
- Whisper walls (companionway only).....
- Plan B forward stateroom layout (in lieu of standard)
- Clear salon carpet cover (in lieu of standard).....
- Steps & companionway runner (canvas).....
- Designer salon chair

INTERIOR WOOD SELECTIONS (satin finish)

- Teak Cherry Walnut
- Hi-gloss finish for interior wood

DECOR

- Accessory package

DELIVERY PREPARATION

- Cost of fuel at time of delivery

Every Ocean Yacht is backed by a transferable Ocean Yachts 5 & 1 Limited Structural Warranty³. Engine, generator, and associated equipment limited warranties are provided by their respective manufacturers. Warranty terms and conditions are available upon request.

Photographs and drawings may contain options or other features not covered by the base price. Ocean Yachts reserves the right to make changes to its standard or optional equipment list or to what is shown in visual representations of its models in advertising and sales materials. Ocean Yachts may do so at any time and without prior notice. Ocean Yachts also reserves the right to make such changes without incurring any obligations to equip or modify boats or models manufactured prior to the effective date of such change.

¹Generator is not intended to supply power for all standard and optional equipment. Load must be limited to generator output rating. ²Capacities of tanks are estimates and useable volume will vary depending upon installation requirements and other conditions. ³Ocean Yachts 5 & 1 Limited Structural Warranty does not extend to any gel-coat finishes. Colored gel-coat finishes are susceptible to fading. Ocean Yachts are constructed to meet or exceed all NMMA, ABYC, and US Coast Guard standards.

Optional equipment prices are subject to change. Fuel extra at delivery. Lettering of transom with original order.



The Best Part Of Life Is Spent On An Ocean

Ocean Yachts | P.O. Box 702, Egg Harbor City, New Jersey 08215
609-965-4616 / 609-965-3517 | oceanyachtsinc.com | eggharboryachts@gmail.com